

## Resetting your watch using a Windows Machine

Make sure device is connected to computer through USB charging cable

Firstly, install Google USB drivers:

Go to: <https://developer.android.com/studio/run/win-usb>

- chose **Download the Google USB Driver ZIP file (ZIP)**.
- Scroll through and accept the T&Cs

I have read and agree with the above terms and conditions

**Download the Google USB driver**

latest\_usb\_driver\_windows.zip

- Download and unzip the drivers
- Ensure your Pixel watch 2 is plugged into your computer
- From the windows search bar, search for device management
- Look through the options to find Google Pixel Watch 2. It could be under “Universal Serial Bus Devices”
- Right click and select “Update driver”

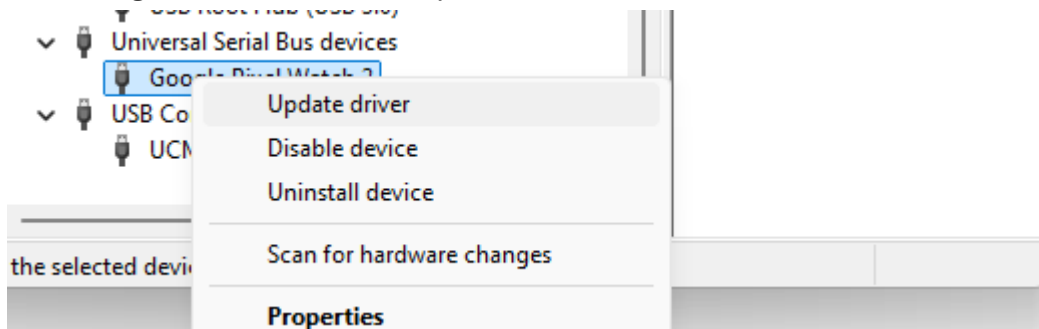

- Select “browse my computer for drivers”
- Find where you downloaded the drivers to (most cases this will be the download folder. Only select the top-level folder and ensure “include sub-folders” is ticked.

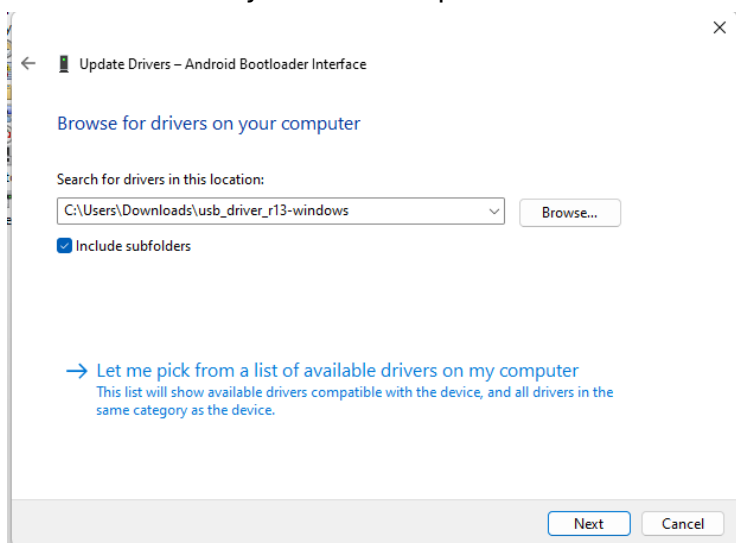

- Click “Next”. The drivers should then be installed.
- Continue to steps to reset the watch below.

Resetting Pixel Watch:

Go to [flash.android.com](https://flash.android.com)

Click on “Get Started”

Click on “Already installed”

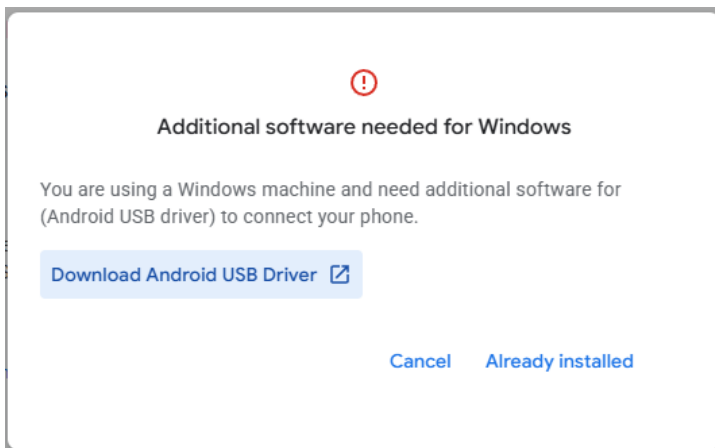

On the pop up window click on “Allow ADB access”

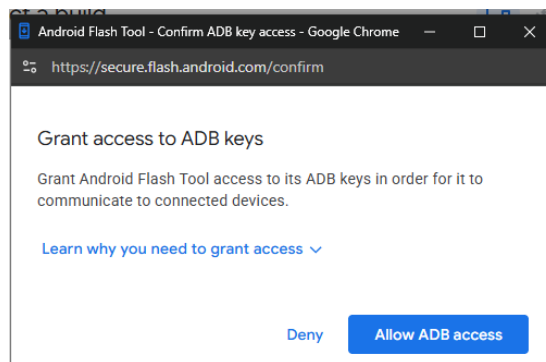

*If a pop up does not appear it may be that it has been blocked. From the address bar at the top click the “pop up blocked icon” and select always allow from “flash.android.com”*

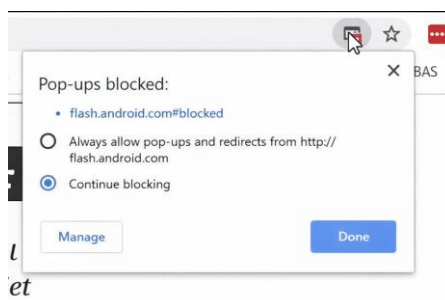

On “Select a build” screen, click on “+ Add new device”

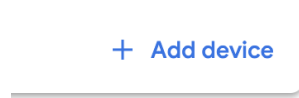

On “Select a build” screen, click on “+ Add new device”

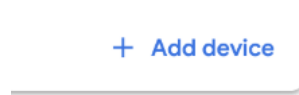

Pop up window should have “Google Pixel Watch 2”, click on it and click “Connect”

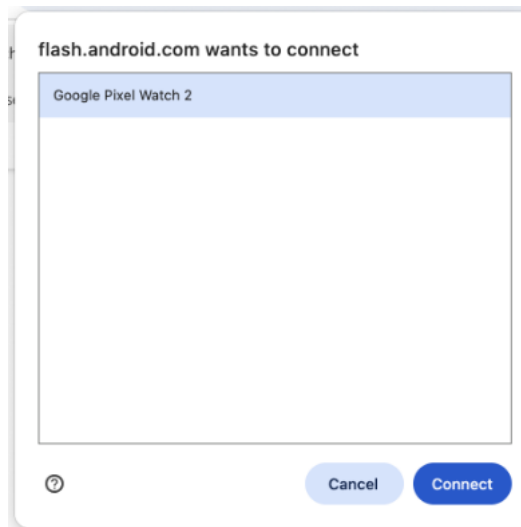

From “Popular builds”, click on “Back to Public”

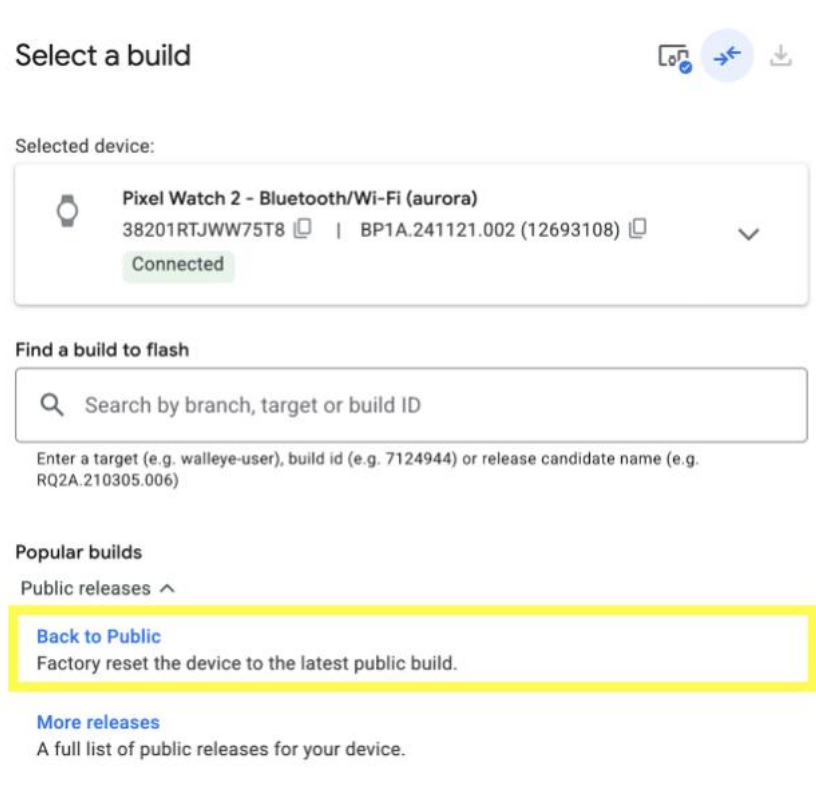

On “Selected build” click on “Install build”

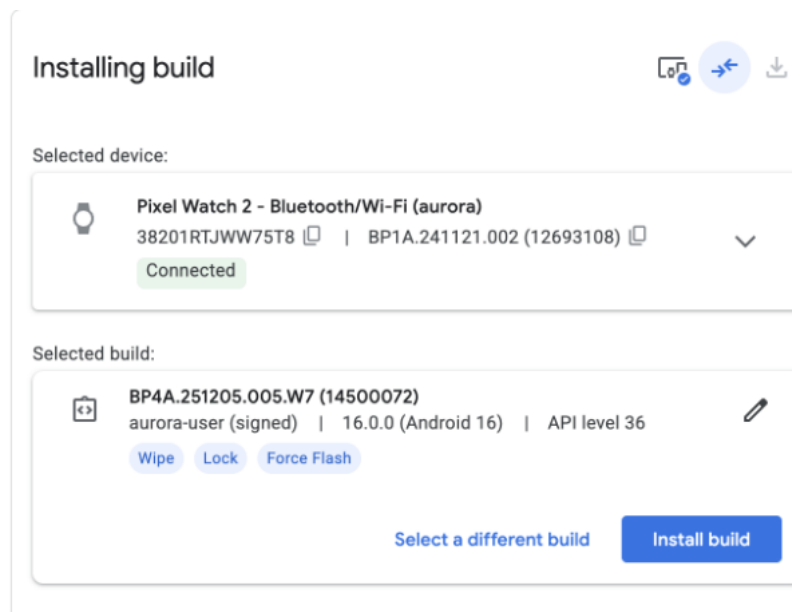

On Popup window, click on “Confirm”

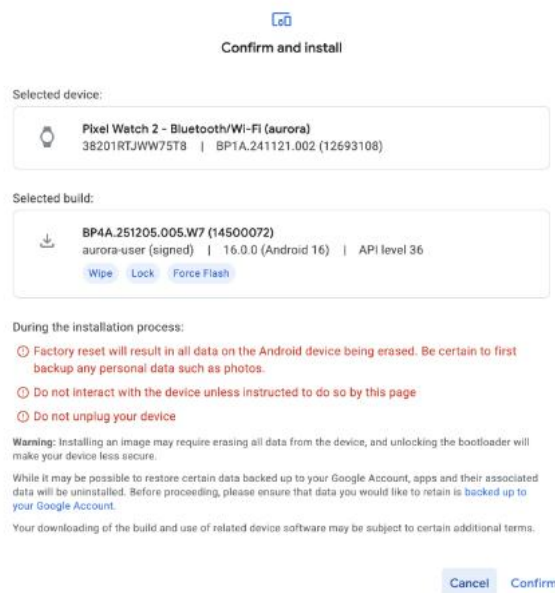

On follow up popup window, click on “Accept”

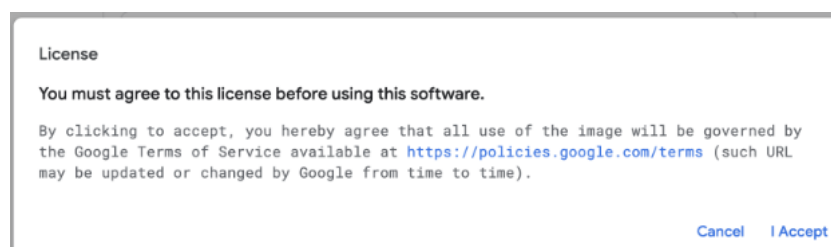

In the process, it will prompt you to "Reselect your device”

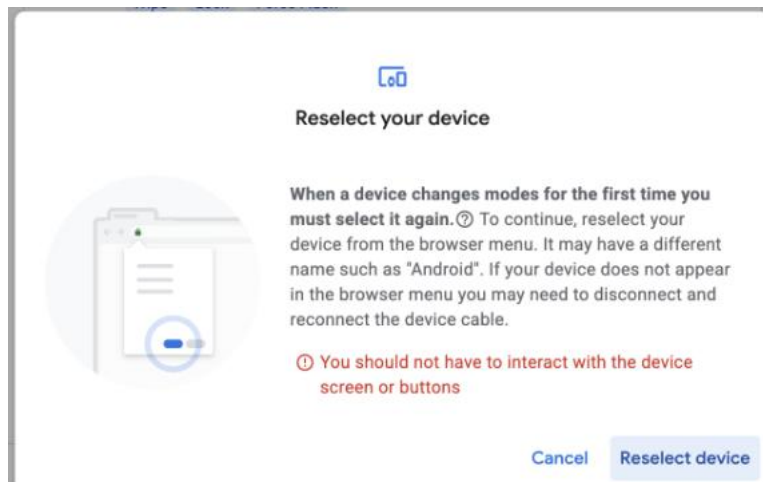

Choose "Google Pixel Watch 2" from the pop up (as before) and click Connect

During the processing (approx 5-10mins) the progress bar will appear.

Once complete you will see "install complete" showing the browser.



## Installing build

Selected device:



**Pixel Watch 2 - Bluetooth/Wi-Fi (aurora)**  
38201RTJWW75E3 | BP1A.241121.002 (12693108)

Selected build:



**BP4A.251205.005.W7 (14500072)**  
aurora-user (signed) | 16.0.0 (Android 16) | API level 36

[Wipe](#) [Lock](#) [Force Flash](#)

Current status:



### Install Complete

The build has been successfully installed. It is now safe to unplug your device.

[Flash another build](#)